

CARBON FIBER TRAIN TUNNEL CMU WALL STRENGTHENING

VANCOUVER, BRITISH COLUMBIA



In November 2022, Canada Line SkyTrain, a prominent transportation authority in Vancouver, British Columbia, faced a challenge involving the structural integrity of a CMU partition wall at one of its key transit facilities, specifically within the Waterfront Station tunnels.



This deteriorating CMU wall displayed signs of cracking and damage near the top of the wall. Prioritizing passenger safety, Canada Line SkyTrain enlisted the expertise of Retro Specialty Contractors

To address this challenge, Retro Specialty Contractors (Retro) reached out to SRS for help in developing a reinforcement plan for the wall utilizing Carbon Fiber Reinforced Polymer (CFRP).

Learn more at [Structuralrs.com](https://www.Structuralrs.com)

1-888-292-2592

Made in the USA

CARBON FIBER STRENGTHENING SYSTEMS

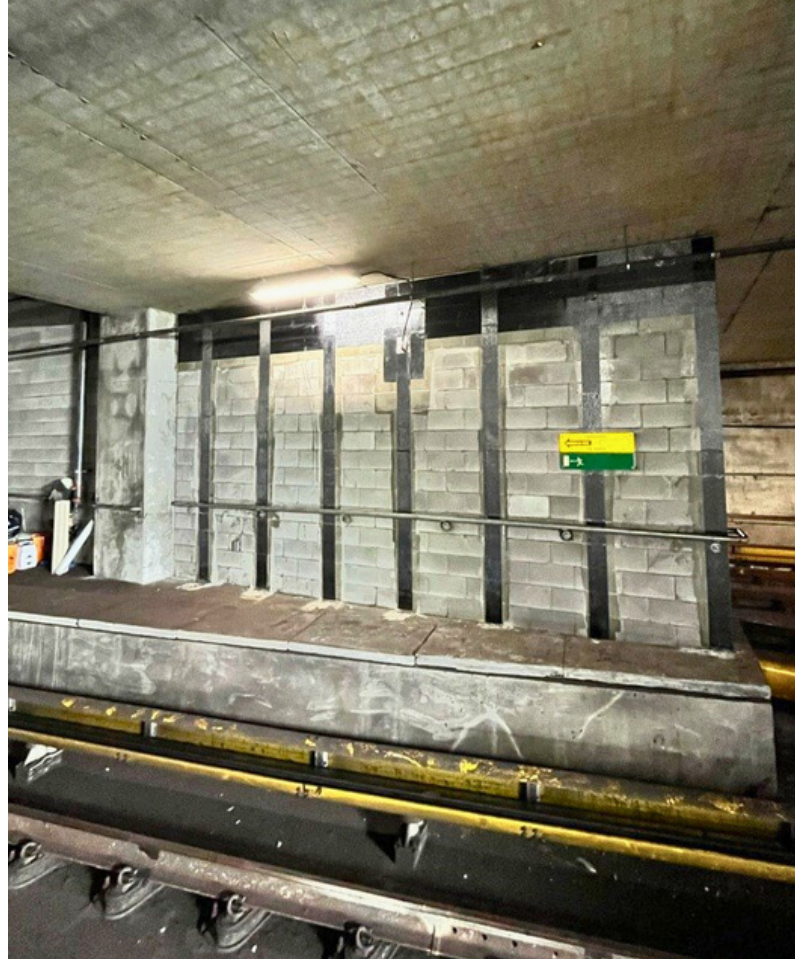

The upper 2' of the wall was confined with SRS-600UNI to provide reinforcement where cracking had occurred. Additionally, 6" wide SRS-600UNI was installed vertically at 3' centers on both faces of the wall to increase the flexural strength and reinforce the wall against future failures.

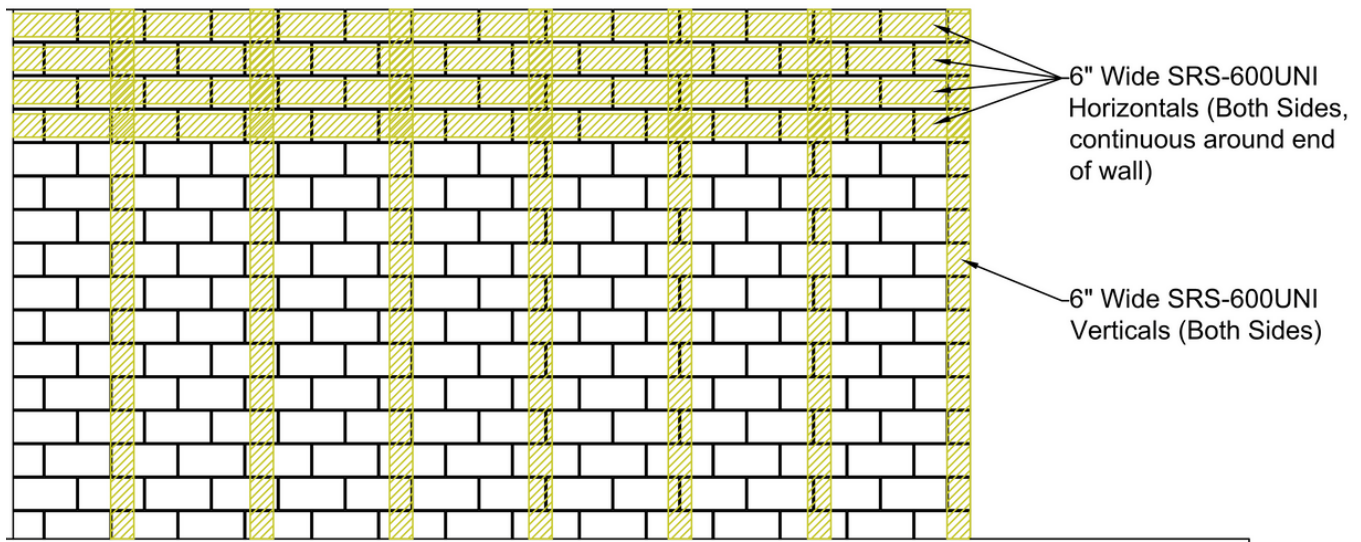

The collaborative approach of SRS and Retro Specialty Contractors delivered a comprehensive, safe, and efficient solution that met the immediate needs and long-term goals of Canada Line SkyTrain, ensuring passenger safety, facility integrity, with no operational down time.

Learn more at [Structuralrs.com](https://www.Structuralrs.com)

1-888-292-2592

Made in the USA

